

## News release

For immediate release  
9 July 2008

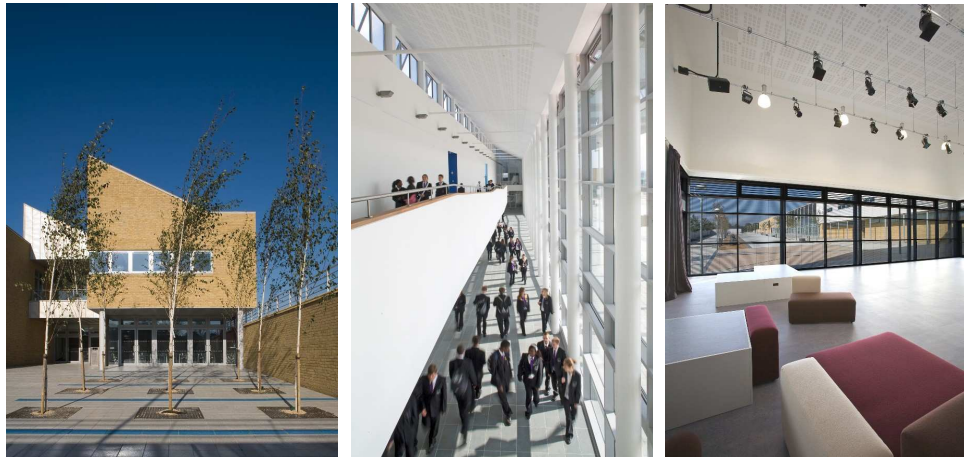

Everest Community College, Sherborne-St-John, Basingstoke. Images by Andy Major.

## Can Schools be Sustainable?

### RIBA South holds 'Green Ideas for School Design' Conference, Wednesday, 17 September

The Royal Institute of British Architects (RIBA) South is holding a one day conference which will address green ideas for school design on Wednesday, 17th September at Everest Community College, Sherborne-St-John, Basingstoke from 9 am – 4.30 pm. Sponsored by The Rooflight Company, the conference, which is part of RIBA South's Green Group activities, principally focuses on the increasing recognition of the need for quality design and attention to detail in achieving any sustainable objectives. It also challenges the need to identify and embrace those elements and available guidance that enable better schools to be delivered and to ensure that the benefits and opportunities are disseminated to a wide audience.

Isabel Carmona, RIBA South's Green Group representative, will chair the conference. She commented: "The 'Green Ideas for School Design' Conference will discuss school design from conception to the realities of buildings in use. There will be speakers from all aspects of school design and sustainability who will enlighten and enhance the audience's understanding of the issues. It is aimed at key players involved in school design and construction, namely architects, contractors, planners and other local authority officers, developers and investors, school designers as well as school headteachers and bursars."

Linda Mills, Regional Director, RIBA South commented: "The conference will give everyone food for thought in terms of improving design quality and making our future schools not only more sustainable but better learning environments. There is very real evidence that improved buildings can help motivate pupils to succeed."

Presentations by speakers at the 'Green Ideas for School Design' conference will include:

- A Headteacher's Perspective on Designing a New School - Keith Grainger, Principal, Garth Hill School
- The Everest Community College Project - Andy Pritchard, Architect, Hants County Council Architecture & Design
- What's the Big Idea? - Craig Anders, Cole Thompson Anders
- School Design – Luton Academies and their carbon footprint - Nick Mirchandani, Architecture PLB & Peter Hazzard, Cundall
- What does a Carbon-neutral school look like? - Roderic Bunn, BSRIA
- Sustainable Schools: Fiction or Reality? – Adrian Leaman, Usable Buildings Trust

Places are available at £95+VAT (£111.63) per delegate, or at an Early Bird Price of £90+VAT (£105.75) if booked before 1 August. Booking forms are available from our website [www.architecture.com/ribasouth](http://www.architecture.com/ribasouth) under Continuing Professional Development or directly from RIBA South, T: 0118 969 8051, F: 0118 969 6954 or E: [riba.south@inst.riba.org](mailto:riba.south@inst.riba.org).

Everest Community College and Youth Service Building are an entirely new campus of buildings providing a fresh start for the existing John Hunt of Everest School. The construction of the new campus is designed around sustainable objectives, maximising low energy design and natural ventilation including night time cooling, an array of photo-voltaic cells, and the planned installation of a wind turbine in 2008. Completed in July 2007, the buildings offer state of the art facilities and a stimulating and inspirational environment for staff, pupils and the wider community within landscaped grounds adjacent to a new public square.

‘Green Ideas for School Design’ is sponsored by



Ends

**Notes to the editor:**

1. For further information, images or interview, contact RIBA South Press Officer, Carri Crook, Carisma Communications, on 01842 815910 or via [carri@carismacommunications.co.uk](mailto:carri@carismacommunications.co.uk).
2. RIBA South is based at 2A The Stables, Sandford Farm, Woodley, Reading RG5 4SU.
3. RIBA South consists of 1,600 registered architects and 300 registered practices. The RIBA South Region covers Berkshire, Buckinghamshire, Hampshire, the Isle of Wight and Oxfordshire.
4. For further information on the conference, please contact Linda Mills, Regional Director, RIBA South on 0118 969 8051 or email [linda.mills@inst.riba.org](mailto:linda.mills@inst.riba.org) or Lucy Mayfield on 0118 969 8051 or email [lucy.mayfield@inst.riba.org](mailto:lucy.mayfield@inst.riba.org).